

**KARABINERHAKEN, PANIKHAKEN  
CARBINE HOOKS, PANICHOOKS**



**KONG®** asymmetrischer Karabinerhaken, Aluminium farb  
*Carbine hooks, asymmetric form, coloured anodized Aluminium*

Art.-No.		La mm	D1 mm	Ø1 mm	Ø2 mm	Gewicht weight g	BRL kg
<b>NB 5053</b>	Key-Lock	52	5	7,5	9,0	12 g	150
<b>NB 5063</b>	Key-Lock	65	6	8,0	12,0	14 g	150
<b>NB 5083</b>	Key-Lock	85	8	12,0	18,0	27 g	600

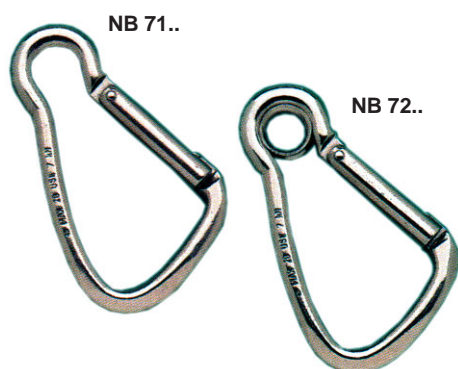

Standard - Form

<b>KK 5505-10</b>	VP á 10 Stück	50	5	8	8,0	6 g	-
<b>KK 5506-10</b>	VP á 10 Stück	60	6	9	9,0	10 g	-
<b>KK 5508-10</b>	VP á 10 Stück	80	8	11	10,0	23 g	-



**KONG®** asymmetrische Karabinerhaken aus Edelstahl 1.4401  
*KONG® asymmetrical carbine hooks, stainless steel AISI 316*

<b>NB 7150</b>	Key-Lock	52	5	7,5	9,0	24 g	-
<b>NB 7160</b>	Key-Lock	65	6	8,0	12,0	35 g	-
<b>NB 7180</b>	Key-Lock	85	8	12,0	18,0	75 g	800
<b>NB 7110</b>	Key-Lock	100	10	13,0	19,0	144 g	1.200
<b>NB 7112</b>	Key-Lock	125	11	18,0	26,0	210 g	2.000
<b>NB 7250</b>	Key-Lock	52	5	6,0	9,0	26 g	-
<b>NB 7260</b>	Key-Lock	65	6	7,0	12,0	37 g	-
<b>NB 7280</b>	Key-Lock	85	8	10,0	18,0	77 g	800
<b>NB 7210</b>	Key-Lock	100	10	11,5	19,0	148 g	1.200
<b>NB 7212</b>	Key-Lock	125	11	15,0	26,0	217 g	2.000

**KONG® PANIKHAKEN / SPECIAL HOOK**

Spezialhaken aus Edelstahl 1.4401 zum schnellen Abwerfen  
*Special hook in stainless steel AISI 316*

Art.-No.	BRL kg
<b>NB 525</b>	1.000

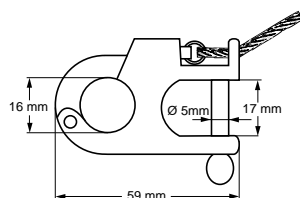

**Wasserski-Zubehör finden Sie im Kapitel 13,  
Motorbootzubehör  
You will find waterski equipment in chapter 13,  
motorboat equipment**

